

The Comfort

1 base + extensions

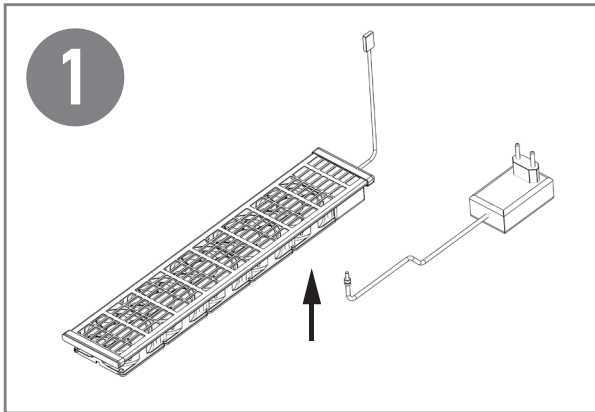

Remove the products from the packaging and check the contents. Connect the adapter to the base.

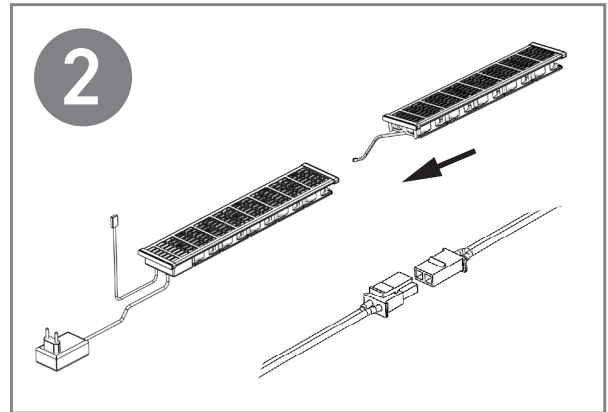

Connect the base + (several) extensions (depending on the length of the radiator) together using the connectors.

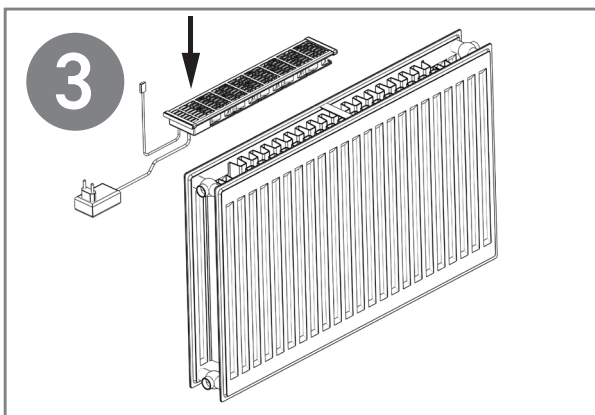

Place the Comfort and any extensions on the top of the radiator.

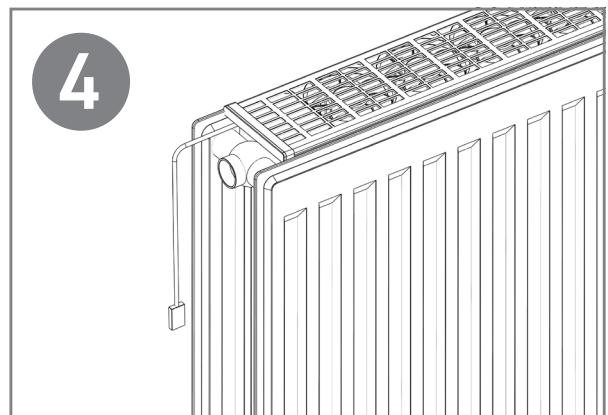

Place the magnetic temperature sensor between the radiator plates on the supply side (the side with the knob). Connect the power adapter to the nearest socket. The Comfort is now ready for use.